

# ÜBERSICHTSZEICHNUNG

ASSEMBLY DRAWING

**GHOST**



SLAMR X6 (MY17)

2017-02-23 02

V02

# ÜBERSICHTSZEICHNUNG ASSEMBLY DRAWING

# GHOST

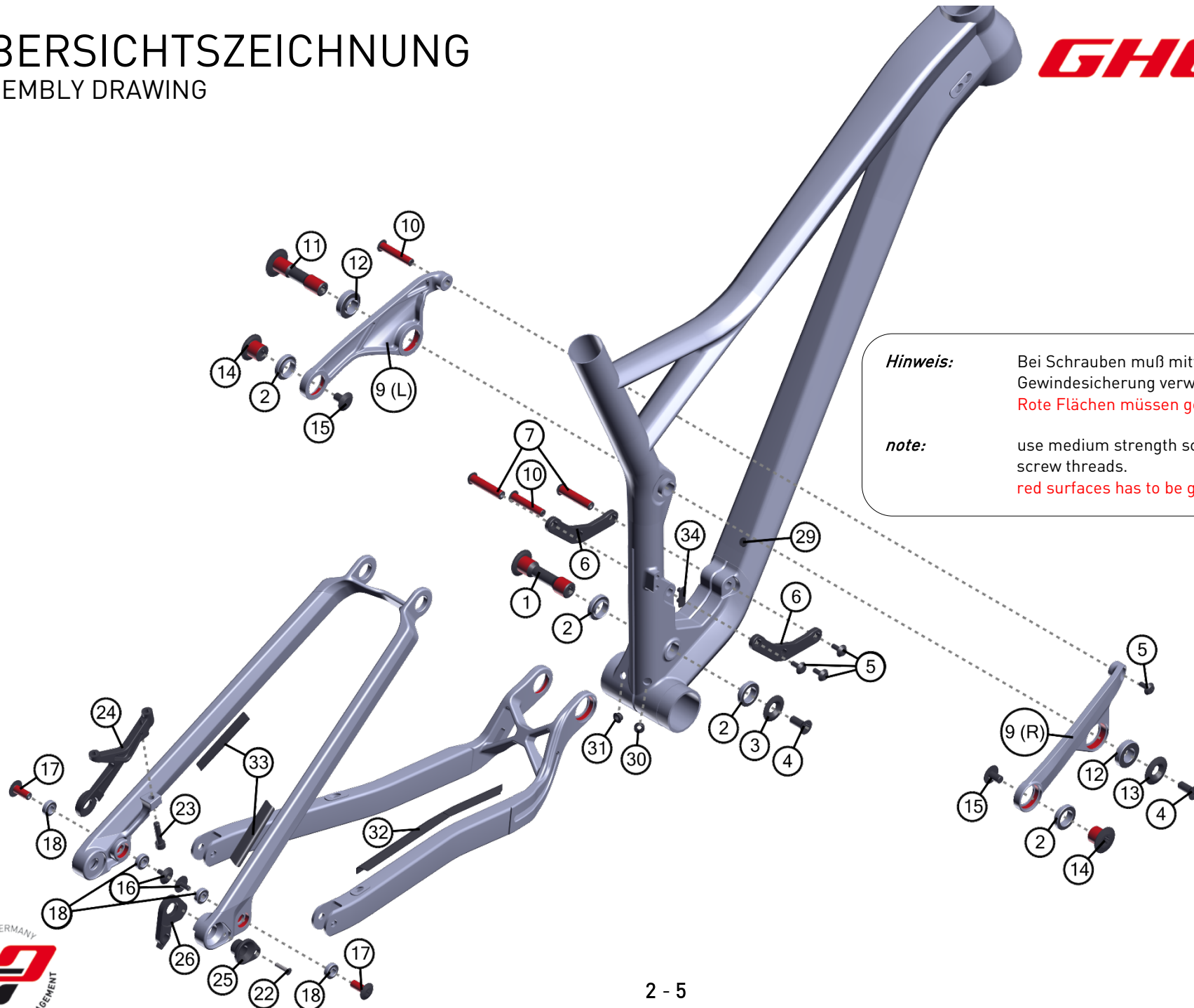

**Hinweis:** Bei Schrauben muß mittelfeste Gewindesicherung verwendet werden.  
**Rote Flächen müssen gefettet werden.**

**note:** use medium strength screwlock for screw threads.  
**red surfaces has to be greased.**



# ÜBERSICHTSZEICHNUNG

## ASSEMBLY DRAWING

# GHOST

BOM-ID	Description	Specification	Torque	Drawing no.	Item no.	QTY
1	Axel Main Pivot	T50 - $\varnothing$ 17 (M8) x 64,7mm	8 Nm		SM1364	1
2	Main Pivot & Seat Stay Pivot				SM1379	4
3	Nut Main Pivot				SM1370	1
4	Flat Head Screw M8	T30 - M8 x 20mm	8 Nm or 12 Nm		SM1375	2
5	Screw Shock Mount	T25 - M5 x 12mm	6 Nm		SM1377	4
6	Shock Mount				FROT0018	2
7	Axle Shock Mount	T30 - $\varnothing$ 9 (M5) x 40mm	6 Nm		FRAX0001	2
9 (L)	Rocker (left)				FROT0017	1
9 (R)	Rocker (right)				FROT0017	1
10	Axle Shock	T30 - $\varnothing$ 8 (M5) x 40mm	6 Nm		SM1368	2
11	Axle Rocker Fix Pivot	T50 - $\varnothing$ 15 (M8) x 62,5mm	12 Nm		SM1365	1
12	Seat Tube - Rocker Pivot Bearing				SM1380	2
13	Nut Rocker Fix Pivot				SM1371	1
14	Axle Seat Stay Pivot	T50 - $\varnothing$ 17 (M8) x 13,5mm	8 Nm		SM1366	2
15	Screw SS Yoke	T30 - M8 x 13mm	8 Nm		SM1378	2
16	Screw CS&DO	T25 - M5 x 11mm	6 Nm		SM1376	2
17	Axle Horst Link	T30 - $\varnothing$ 8 (M5) x 18,9mm	6 Nm		SM1363	2
18	Horst Link Pivot Bearing				SM1381	4
22	Flat Head Screw M4	T15 - M4 x 20mm	0,8 Nm		FRSC0060	1
23	Post Mount Screw	T30 - M6 x 26mm	8 Nm		SM1372	1
24	Disc Brake Mount				SM1387	1
25	Hanger Mount				FRNT0061	1
26	SRAM Hanger (A2)				FRHG0057	1
29	DT cap closed				SM1397	1
30	BB cap RD				SM1389	1
31	BB cap BR				SM1390	1
32	CS Protector				SR0617	1
33	SS Protector				SM1392	2
34	FD cap				SM1396	1

# ÜBERSICHTSZEICHNUNG

## ASSEMBLY DRAWING

**GHOST**

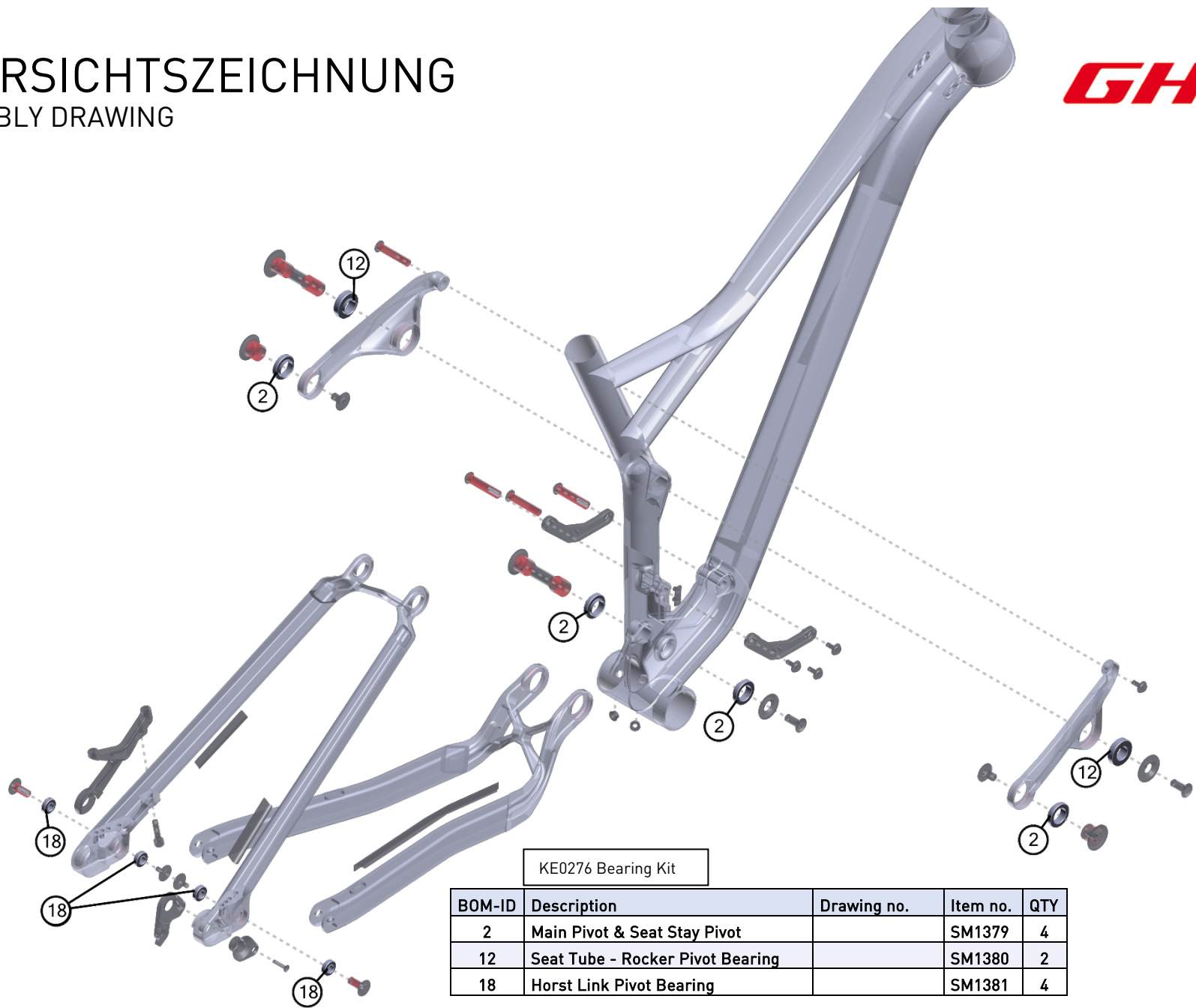

BOM-ID	Description	Drawing no.	Item no.	QTY
2	Main Pivot & Seat Stay Pivot		SM1379	4
12	Seat Tube - Rocker Pivot Bearing		SM1380	2
18	Horst Link Pivot Bearing		SM1381	4

# ÜBERSICHTSZEICHNUNG

## ASSEMBLY DRAWING

**GHOST**

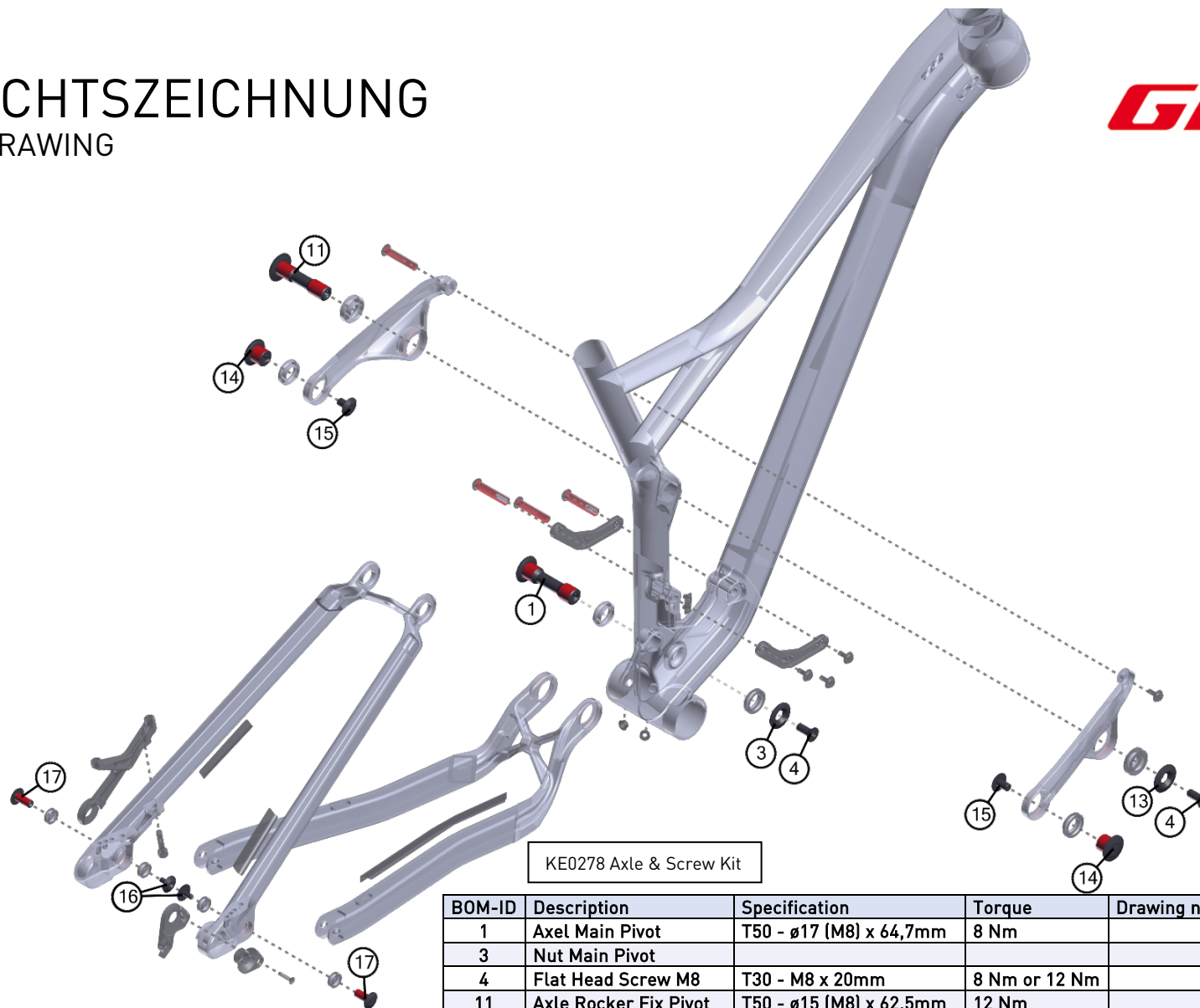

KE0278 Axle & Screw Kit

BOM-ID	Description	Specification	Torque	Drawing no.	Item no.	QTY
1	Axel Main Pivot	T50 - ø17 (M8) x 64,7mm	8 Nm		SM1364	1
3	Nut Main Pivot				SM1370	1
4	Flat Head Screw M8	T30 - M8 x 20mm	8 Nm or 12 Nm		SM1375	2
11	Axle Rocker Fix Pivot	T50 - ø15 (M8) x 62,5mm	12 Nm		SM1365	1
13	Nut Rocker Fix Pivot				SM1371	1
14	Axle Seat Stay Pivot	T50 - ø17 (M8) x 13,5mm	8 Nm		SM1366	2
15	Screw SS Yoke	T30 - M8 x 13mm	8 Nm		SM1378	2
16	Screw CS&DO	T25 - M5 x 11mm	6 Nm		SM1376	2
17	Axle Horst Link	T30 - ø8 (M5) x 18,9mm	6 Nm		SM1363	2

SLAMR X6 (MY17)

2017-02-23 02

V02